

PRODUCT INSTALLATION GUIDE

12 Gauge Deluxe Shotgun Heatshield w/ Ghost Ring Sights



HARDWARE INCLUDED

-  [2] 4-40 x 3/16 Phillips Head Screw
-  non applicable
- [1] #4-40 x 3/8" Flat Head Allen Screw
- [4] 6 x 48/2 x 1/2" Plastiite Phillips Head Screw
-  non applicable

TOOLS NEEDED

-  Phillips Head Screwdriver
-  Allen Set



Warning: When handling a firearm, always follow the proper handling procedures at all times. Failure to follow these procedures could result in serious damage, injury, or death. We are not responsible for damage to property, injury, or death resulting from improper installation, misuse or modification of products. If you are not comfortable completing any of the following steps, or do not have the proper tools enlist the help of your local gunsmith. We are not responsible for components that are damaged due to improper installation.

 You must first install Ghost Ring Sights to the heatshield before installation on your firearm

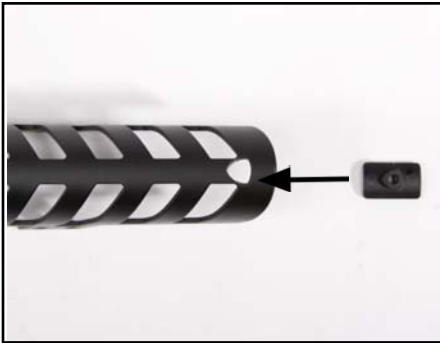

1

Begin by aligning the front sight insert with the center hole as seen in Figure 1.

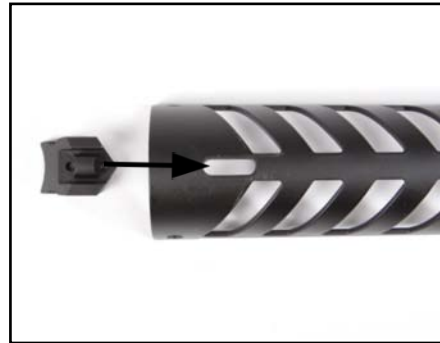

4

Align the rear ghost ring sight as seen in Figure 4 to the rear of the heatshield.
NOTE: Ensure the sight is aligned correctly. The angled side should face forward.



2

Next, snap the insert into the small triangular hole in the front of the heatshield and then align the Ghost Ring Sight onto the top of the heatshield as seen in Figure 2.



5

While holding the rear ghost ring sight in place, turn the heatshield over and insert the provided 4-40 x 3/16" phillips head screw into the base of the rear ghost ring sight. Using a small phillips head screwdriver tighten the screws as seen in Figure 5.



3

While holding onto the sight, flip the heatshield over and using the provided 4-40 x 3/8" flat head socket cap screw and a 1/16" allen driver, tighten to the heatshield as seen in Figure 3.



6

Align the supplied silicone pad to the inside of the clip and press down firmly on the silicone pad for 20-30 seconds along the length of the pad to ensure the silicone pad adheres to the barrel clip properly. Take the rear barrel clip snap it into the rear of the heatshield as seen in Figure 6.

PRODUCT INSTALLATION GUIDE



7

Align the heatshield over the barre and Install the onto the barrel by snapping the heatshield clip onto the rear of the barrel as so it is flush with the receiver as seen in Figure 7.



8

Next, take the spacer and align with the tabs on the heatshield so the holes on the spacer line up with the holes on the tabs as seen in Figure 8. Using a marker, place a line on the spacer about an 1/8" past the beginning of the barrel lug.

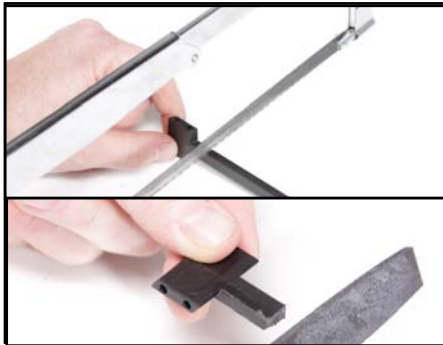

9

Using a hacksaw with a wood or metal blade cut all they way through the marked line on the spacer. After cutting the spacer to the appropriate size use a file to smooth off any loose material as seen in Figure 9.



10

Take the spacer and place in between the barrel and magazine tube making sure the holes in the spacer line up with the holes in the tabs of the heatshield as seen in Figure 10. The long part of the spacer will rest against the barrel lug.
NOTE: You will have to remove the heatshield partially to install the spacer.



11

Using the provide (4) 6 x 48/2 x 1/2" Plastite Phillips Head Screw and a phillips head screwdriver tighten the tabs to the spacer as seen in Figure 11.

Note: If there is wiggle in the heatshield after intalling the screws, you may need to push up on the spacer to make sure it is tight against the bottom of the barrel and than retighten the screws.

